

## Features

- Miniature relay with high switching capability : 30A.
- Contact form : Form A, Form B or 1Form C.
- Protection quick connect terminal type available.

## Safety Approval

UL , C-UL File No. : E190598

TUV File No. : R50143450

CQC File No. : CQC02001002109

## Contact Capacity

Model	SLC -DM	SLC -DB	SLC -D
Nominal switching capacity (res. load)	30A 250VAC	15A 250VAC	20A/10A 250VAC
Max. switching current	30A	20A	20A
Max. switching voltage	250VAC	250VAC	250VAC
Max. switching power	7,500VA	5,000VA	5,000VA

## Charateristic Data

Contact material	Silver alloy	
Initial contact resistance (at 6VDC 1A)	50mΩ Max.	
Operate time (at nominal volt.)	15msec. Max.	
Release time (at nominal volt.)	10msec. Max.	
Initial insulation resistance	1,000MΩ Min.(DC500V)	
Initial dielectric strength	Between open contacts : AC1,500V , 50/60Hz 1Min.	
	Between coil and contact :AC2,500V , 50/60Hz 1Min.	
Vibration resistance	Functional	10 ~ 55Hz at double amplitude of 1.5 mm
	Destructive	10 ~ 55Hz at double amplitude of 1.5 mm
Shock resistance	Functional	10G Min.
	Destructive	100G Min.
Endurance (operations)	Mechanical (at 10,800 ops./h)	10,000,000
	Electrical (at 600 ops./h)	100,000
Ambient temperature	-40°C ~ +105°C (no condensation)	
Unit weight	Approx.31.0g	

## Coil Data(at 20°C)

Nominal voltage (VDC)	Nominal operating current ±10% (mA)	Coil resistance ±10% (Ω)	.Max allowable voltage	Pick-up voltage (Max.)	Drop-out voltage (Min.)	Nominal operating power
5	180.00	27	130 % of nominal voltage	75% of nominal voltage	5 % of nominal voltage	.Approx 0.90W
6	150.00	40				
9	100.00	90				
12	75.00	160				
15	60.00	250				
18	50.00	360				
24	37.50	640				
48	18.75	2,560				
110	8.20	13,400				

### Safety Approval Ratings

Approval	CQC	TUV	UL/CUL
File No.	CQC02001002109	R50143450	E190598
Approved ratings	Form A : 30A 250VAC	Form A : 30A 240VAC	Form A: 40A 277VAC, Resistive; 15A 240VAC; 30A 240VAC, Resistive/General Use; 1-1/2HP 240VAC;3/4 HP 120VAC; TV-8 120VAC; 30A 120VAC, Resistive/General Use; Pilot duty: 470 VA, 240VAC; Electronic Ballast: 10A 277VAC /120VAC;
	Form B : 15A 250VAC	Making: 80A 250VAC(300ms) Breaking:20A 250VAC	Form B: 30A 120VAC, General Use; 20A 240VAC, General Use; 20A 120VAC, Resistive; 10A 240VAC, Resistive/General Use; Pilot duty: 275VA, 240VAC; Electronic Ballast: 5A, 277VAC/120VAC; 1/2HP 240VAC;1/4HP 120VAC;
	Form C : 20A/10A 250VAC	Form B : 15A 240VAC	Form C: N.O. N.C. 30A 240/120VAC,Resistive 30A 240/120VAC,General Use 20A 240/120VAC, Resistive 20A 240VAC, Resistive 20A 240/120VAC,General Use 10A 240VAC, Resistive 10A 240VAC, Resistive 1-1/2HP 240VAC 1/2HP 240VAC 3/4HP 125/120VAC 1/4HP 125/120VAC TV-8 120VAC TV-3 120VAC 20A 240VAC, General Use 10A 240VAC, General Use Pilot Duty: 470VA 240VAC Pilot Duty: 275VA 240VAC Electronic Ballast: Electronic Ballast: 10A 277VAC/120VAC 5A 277VAC/120VAC

### Ordering Information

Nomenclature	
SLC-S-112DMK1-F-XX	Special Parameter : Nil-Standard type, Letter or number-Special requirement
	Insulation System : Nil-Standard, B-Class B, F-Class F
	Contact Material : Nil-AgSnO <sub>2</sub> , 1-AgCdO
	Terminal position : Nil-COM terminal and NO/NC terminal on the same side, K-COM terminal and NO/NC terminal on opposite side
	Contact Form : Nil-Form C, B-Form B, M-Form A
	Coil Power : D-0.90W
	Coil Voltage (VDC) : 05, 06, 09, 12, 15, 18, 24, 48, 110
	Number of Poles : 1-1 Pole
	Protective Construction : S-Flux proofed
	Type Designation : SLC

### Outline Dimensions, Wiring Diagram, P.C. Board Layout (unit : mm)

SLC

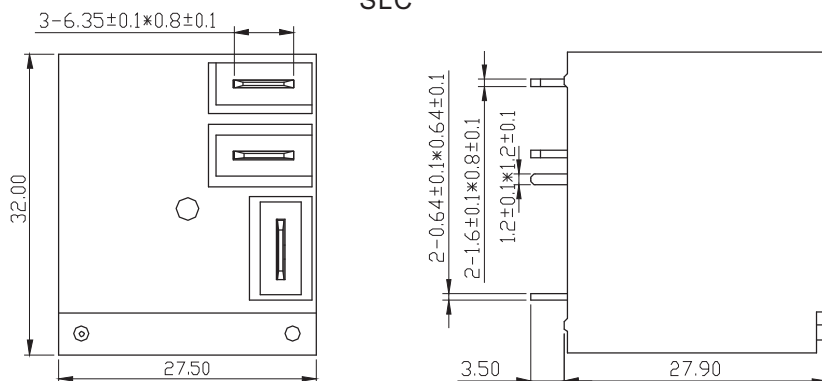

Unless otherwise specified :

- If dimension < 1mm, tolerance : ±0.2mm;
- If dimension 1~5mm, tolerance : ±0.3mm;
- If dimension > 5mm, tolerance : ±0.4mm.

Note : 1. Extended terminal dimension is dimension before soldering.  
2. Tolerance of P.C.B. Layout : ±0.1mm.

SLC-K

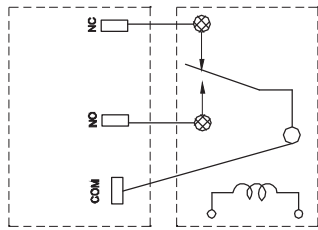
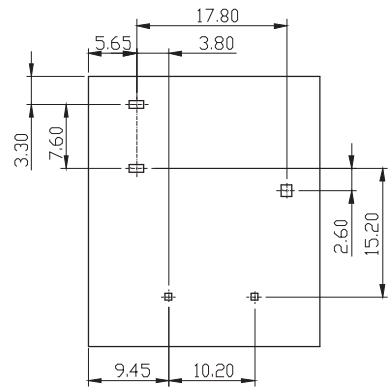
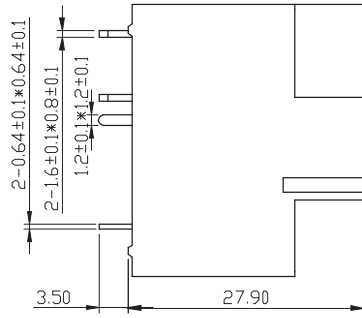
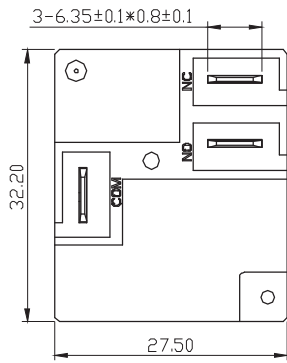

(bottom view)

(top view)

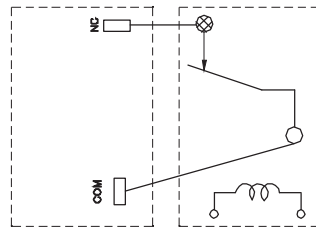

(bottom view)

(top view)

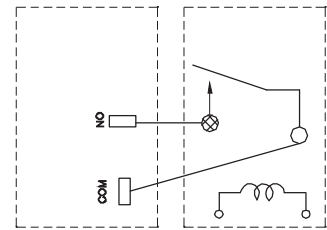

(bottom view)

(top view)

SLC Wiring Diagram

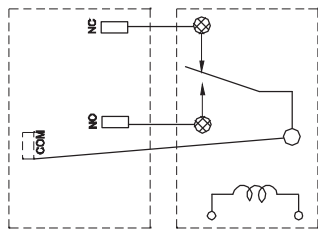

(bottom view)

(top view)

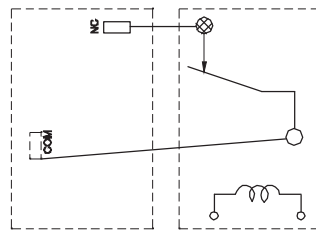

(bottom view)

(top view)

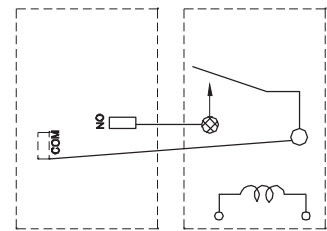

(bottom view)

(top view)

SLC-K Wiring Diagram

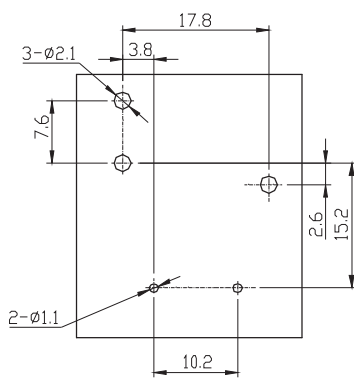

1c

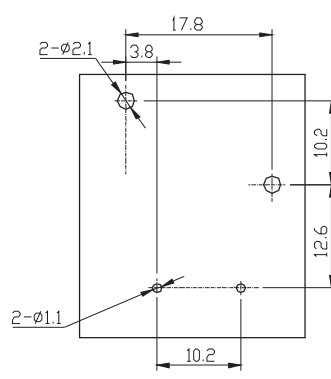

1b

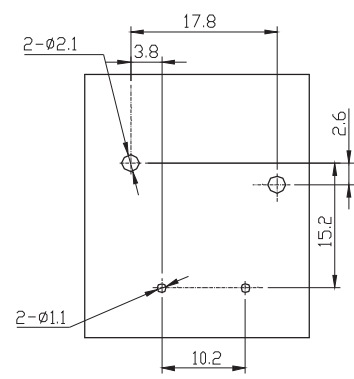

1a

P.C.B Layout (Bottomview)

## Typical Applications

- Car
- Heater and ventilation equipment
- Air conditioner
- Home appliances

## Characteristic Curves

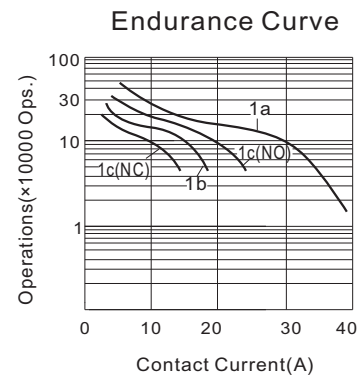
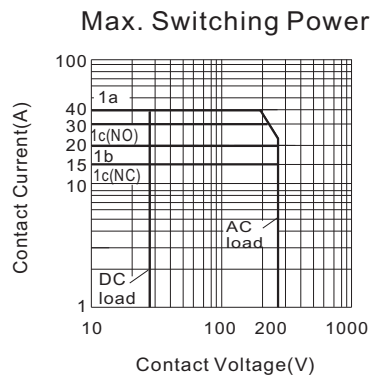
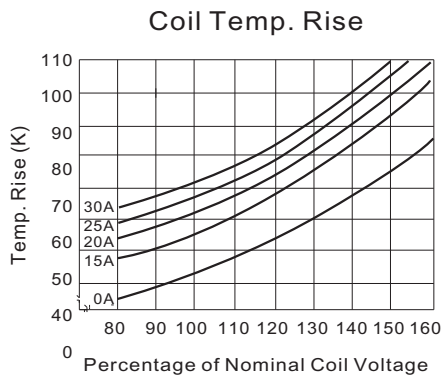

**Disclaimer:**

This datasheet is the customers' reference. All the specification are subject to change without notice. We could not evaluate all the performance and all the parameters for every possible application. Thus the user should in a right position to choose the suitable product for their own application. If there is any query, please contact Sanyou for the technical service. However it is the user's responsibility to determine which product should be used only.